

单位: mm

- ◆ 用于测量曲轴的变形量
- ◆ 平衡块安装在表后盖上可保持百分表面朝上, 便于读数

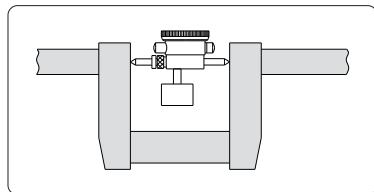

298-012-11

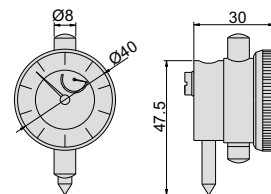

表头

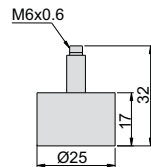

平衡块

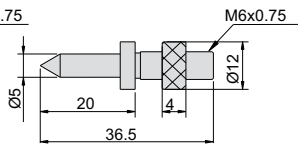
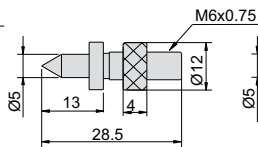
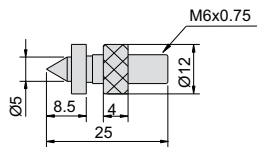

测砧

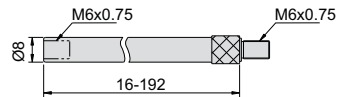

延长杆

货号	量程	表头量程	分度值	精度	延长杆
298-012-11	60-300mm	3mm	0.01mm	±0.016mm	16mm, 32mm, 64mm, 128mm
298-020-11	60-500mm	3mm	0.01mm	±0.016mm	16mm, 32mm, 64mm, 96mm, 128mm, 192mm